

Wafer Sizes: 0.5-in. thru 10-in.
Class: 150, 300, 600

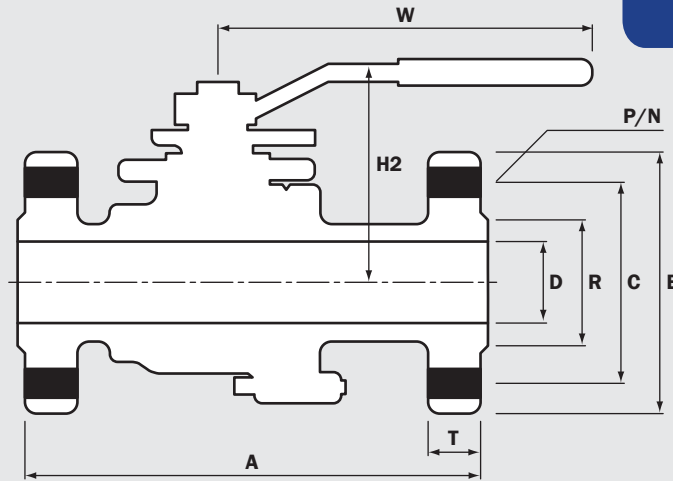

Class 150 – 2-Piece Full Port Flanged Floating Ball Valves

| Size | in. | 0.5 | 0.75 | 1 | 1.5 | 2 | 2.5 | 3 | 4 | 5 | 6 | 8 | 10 |
|--------|-----|-------|-------|-------|-------|-------|-------|-------|-------|-------|-------|-------|-------|
| | mm | 13 | 19 | 25 | 38 | 51 | 64 | 76 | 102 | 127 | 152 | 203 | 254 |
| D | in. | 0.59 | 0.079 | 1 | 1.57 | 1.97 | 2.56 | 3.15 | 3.94 | 4.92 | 5.91 | 7.87 | 9.84 |
| | mm | 15 | 20 | 25.4 | 40 | 50 | 65 | 80 | 100 | 125 | 150 | 200 | 250 |
| A | in. | 4.25 | 4.62 | 5 | 6.5 | 7 | 7.5 | 8 | 9 | 14 | 15.5 | 18 | 21 |
| | mm | 108 | 117 | 127 | 165 | 178 | 191 | 203 | 229 | 356 | 394 | 457 | 533 |
| T | in. | 0.44 | 0.44 | 0.44 | 0.56 | 0.62 | 0.69 | 0.75 | 0.94 | 0.94 | 1 | 1.12 | 1.19 |
| | mm | 11.18 | 11.18 | 11.18 | 14.22 | 15.75 | 17.53 | 19.05 | 23.88 | 23.88 | 25.4 | 28.45 | 30.23 |
| R | in. | 1.38 | 1.69 | 2 | 2.88 | 3.62 | 4.12 | 5 | 6.19 | 7.31 | 8.5 | 10.62 | 12.75 |
| | mm | 35.1 | 42.9 | 50.8 | 73.2 | 91.9 | 104.6 | 127 | 157.2 | 185.7 | 215.9 | 269.7 | 323.9 |
| C | in. | 2.38 | 2.75 | 3.12 | 3.88 | 4.75 | 5.5 | 6 | 7.5 | 8.5 | 9.5 | 11.75 | 14.25 |
| | mm | 60.5 | 69.9 | 79.2 | 98.6 | 120.7 | 139.7 | 152.4 | 190.5 | 215.9 | 241.3 | 298.5 | 362 |
| B | in. | 3.5 | 3.88 | 4.25 | 5 | 6 | 7 | 7.5 | 9 | 10 | 11.00 | 13.5 | 16 |
| | mm | 88.9 | 98.6 | 108 | 127 | 152.4 | 177.8 | 190.5 | 228.6 | 254 | 279.4 | 342.9 | 406.4 |
| P | in. | 0.62 | 0.62 | 0.62 | 0.62 | 0.75 | 0.75 | 0.75 | 0.75 | 0.88 | 0.88 | 0.88 | 1 |
| | mm | 15.75 | 15.75 | 15.75 | 15.75 | 19.05 | 19.05 | 19.05 | 19.05 | 22.35 | 22.35 | 22.35 | 25.4 |
| N | in. | 4 | 4 | 4 | 4 | 4 | 4 | 4 | 8 | 8 | 8 | 8 | 12 |
| | mm | 102 | 102 | 102 | 102 | 102 | 102 | 102 | 203 | 203 | 203 | 203 | 305 |
| H2 | in. | 3.15 | 3.27 | 3.82 | 4.37 | 4.65 | 5.67 | 6.06 | 6.85 | 8.66 | 9.45 | 11.81 | 13.98 |
| | mm | 80 | 83 | 97 | 111 | 118 | 144 | 154 | 174 | 220 | 240 | 300 | 355 |
| W | in. | 5.12 | 5.12 | 6.3 | 9.06 | 9.06 | 15.75 | 15.75 | 18.11 | 21.65 | 21.65 | 39.37 | 39.37 |
| | mm | 130 | 130 | 160 | 230 | 230 | 400 | 400 | 460 | 550 | 550 | 1000 | 1000 |
| Cv | 20 | 50 | 100 | 240 | 240 | 400 | 600 | 1000 | 1700 | 3000 | 4000 | 7400 | 10600 |
| Weight | KG | 2 | 2.8 | 4.1 | 7.5 | 12.5 | 15 | 24.5 | 38 | 50 | 71 | 112 | 240 |

Class 300 – 2-Piece Full Port Flanged Floating Ball Valves

| Size | in. | 0.5 | 0.75 | 1 | 1.5 | 2 | 2.5 | 3 | 4 | 5 | 6 | 8 | 10 |
|--------|-----|-------|-------|-------|-------|-------|-------|-------|-------|-------|-------|-------|-------|
| | mm | 13 | 19 | 25 | 38 | 51 | 64 | 76 | 102 | 127 | 152 | 203 | 254 |
| D | in. | 0.59 | 0.079 | 1 | 1.57 | 1.97 | 2.56 | 3.15 | 3.94 | 4.92 | 5.91 | 7.87 | 9.84 |
| | mm | 15 | 20 | 25.4 | 40 | 50 | 65 | 80 | 100 | 125 | 150 | 200 | 250 |
| A | in. | 5.5 | 6 | 6.5 | 7.5 | 8.5 | 9.5 | 11.12 | 12 | 15 | 15.88 | 19.75 | 22.38 |
| | mm | 140 | 152 | 165 | 191 | 216 | 241 | 282 | 305 | 381 | 403 | 502 | 568 |
| T | in. | 0.56 | 0.62 | 0.69 | 0.81 | 0.88 | 1 | 1.12 | 1.25 | 1.38 | 1.44 | 1.62 | 1.88 |
| | mm | 14.22 | 15.75 | 17.53 | 20.57 | 22.35 | 25.4 | 28.45 | 31.75 | 35.05 | 36.58 | 41.15 | 47.75 |
| R | in. | 1.38 | 1.69 | 2 | 2.88 | 3.62 | 4.12 | 5 | 6.19 | 7.31 | 8.5 | 10.62 | 12.75 |
| | mm | 35.1 | 42.9 | 50.8 | 73.2 | 91.9 | 104.6 | 127 | 157.2 | 185.7 | 215.9 | 269.7 | 323.9 |
| C | in. | 2.62 | 3.25 | 3.5 | 4.5 | 5 | 5.88 | 6.62 | 7.88 | 9.25 | 10.62 | 13 | 15.25 |
| | mm | 66.5 | 82.6 | 88.9 | 114.3 | 127 | 149.4 | 168.1 | 200.2 | 235 | 269.7 | 330.2 | 387.4 |
| B | in. | 3.75 | 4.62 | 4.88 | 6.12 | 6.5 | 7.5 | 8.25 | 10 | 11 | 12.5 | 15 | 17.5 |
| | mm | 95.3 | 117.3 | 124 | 155.4 | 165.1 | 190.5 | 209.6 | 254 | 279.4 | 317.5 | 381 | 444.5 |
| P | in. | 0.62 | 0.62 | 0.62 | 0.62 | 0.75 | 0.75 | 0.75 | 0.75 | 0.88 | 0.88 | 0.88 | 1 |
| | mm | 15.75 | 15.75 | 15.75 | 15.75 | 19.05 | 19.05 | 19.05 | 19.05 | 22.35 | 22.35 | 22.35 | 25.4 |
| N | in. | 4 | 4 | 4 | 4 | 8 | 8 | 8 | 8 | 8 | 12 | 12 | 16 |
| | mm | 102 | 102 | 102 | 102 | 203 | 203 | 203 | 203 | 203 | 305 | 305 | 406 |
| H2 | in. | 2.48 | 2.68 | 2.99 | 3.46 | 3.7 | 4.53 | 4.72 | 7.68 | 8.66 | 9.45 | 11.81 | 13.98 |
| | mm | 63 | 68 | 76 | 88 | 94 | 115 | 120 | 195 | 220 | 240 | 300 | 355 |
| W | in. | 5.12 | 5.12 | 6.3 | 9.06 | 9.06 | 15.75 | 15.75 | 18.11 | 21.65 | 21.65 | 39.37 | 39.37 |
| | mm | 130 | 130 | 160 | 230 | 230 | 400 | 400 | 460 | 550 | 550 | 1000 | 1000 |
| Cv | 20 | 50 | 100 | 240 | 240 | 400 | 600 | 1000 | 1700 | 3000 | 4000 | 7400 | 10600 |
| Weight | KG | 2.8 | 3.9 | 5.6 | 10.5 | 12 | 14.2 | 30 | 46 | 70 | 89 | 154 | 273 |

Long pattern available on 2-in. 203mm, 3-in. 241mm and 4-in. 305mm (class 150 only).

Face to face dimensions to ANSI B16.10.

The Flow Coefficiency (Cv) of a valve is the rate of gallons per minute of water at 60°F through a fully opened valve at a pressure drop of 1 PSI across the valve.

Dimensions and values should only be used as a guide.

Please contact us if you require a specific drawing or confirmation of dimensions and values.