

Class: 150 thru 2500
Sizes: 2-in. thru 36-in. (and larger)

GEAR OPERATED

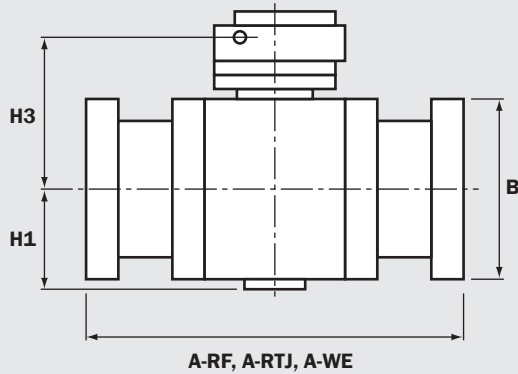

LEVER OPERATED

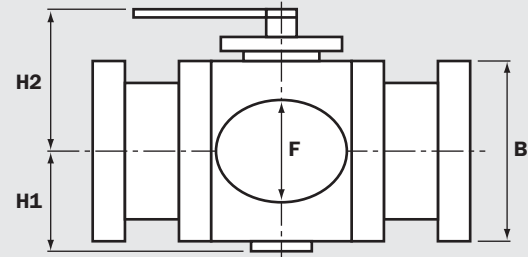

CLASS 150 – Trunnion Mounted Ball Valves

Size	Bore	End to End Dimensions						Body Dimensions			Flanged Weight		Butt Weld Weight	
		F (in.)	A-RF (in.)	A-RF (mm)	A-RTJ (in.)	A-RTJ (mm)	A-WE (in.)	A-WE (mm)	H1 (in.)	H2 (in.)	H3 (in.)	LB	KG	LB
2 x 2	2	7	178	7.5	190.5	8.5	216	4.44	6.5	8.9	39.6	18	28.6	13
3 x 2	2	8	203	8.5	216	11.125	283	5.22	7.28	9.68	48.4	22	33	15
3 x 3	3	8	203	8.5	216	11.125	283	5.56	8.69	11.09	68.2	31	52.8	24
4 x 3	3	9	229	9.5	241	12	305	6.34	9.47	11.87	88	40	74.8	34
4 x 4	4	9	229	9.5	241	12	305	6.5	9.56	11.96	118.8	54	94.6	43
6 x 4	4	15.5	394	16	406	18	457	7.28	10.34	12.74	149.9	68	118.8	54
6 x 6	6	15.5	394	16.5	419	18	457	8.69	12.19	14.59	497.2	226	398.2	181
8 x 6	6	18	457	18.5	470	20.5	521	9.47	13.29	15.59	598.4	272	497.2	226
8 x 8	8	18	457	18.5	470	20.5	521	10.38	14.8	17.2	748	340	646.8	294
10 x 8	8	21	533	21.5	546	22	559	11.16	15.9	18.3	847	385	748	340
10 x 10	10	21	533	21.5	546	22	559	12.13	16.63	19.78	1196.8	544	1047.2	476
12 x 10	10	24	610	24.5	622	25	635	13.23	17.84	20.98	1496	680	1346.4	612
12 x 12	12	24	610	24.5	622	25	635	13.88	18.69	21.84	1696.2	771	1546.6	703
14 x 12	12	27	686	27.5	699	30	762	14.98	20	23.04	1845.8	839	1645.6	748
14 x 14	13.25	27	686	27.5	699	30	762	15.5	21	24.15	2343	1065	2145	975
16 x 14	13.25	30	762	30.5	775	33	838	16.6	22.3	25.45	2593.8	1179	2343	1065
16 x 16	15.25	30	762	30.5	775	33	838	17.19	22.75	26.75	3042.6	1383	2743.4	1247
18 x 16	15.25	34	864	34.5	876	38	965	18.39	24.05	28.05	3440.8	1564	3093.2	1406
18 x 18	17.25	34	864	34.5	876	38	965	18.75	25.75	29.8	4389	1995	3940.2	1791
20 x 18	17.25	36	914	36.5	927	39	991	20.05	27.05	31.1	7139	3245	4439.6	2018
20 x 20	19.25	36	914	36.5	927	39	991	20.5	27.05	32.5	5288.8	2404	4789.4	2177
24 x 20	19.25	42	1067	42.5	1080	45	1143	21.9	28.8	33.9	5588	2540	5137	2335
24 x 24	23.25	42	1067	42.5	1080	45	1143	24.38	32.8	36.67	8681.2	3946	7933.2	3606
26 x 26	25	45	1143	45.5	1156	49	1245	34.83	50	55.91	10476.4	4762	9429.2	4286
28 x 28	27	49	1245	49.5	1257	53	1346	36.4	52.45	58.36	11974.6	5443	10775.6	4898
30 x 30	29	51	1295	51.5	1308	55	1397	38.77	55.75	61.95	14966.6	6803	13470.6	6123
36 x 36	34.5	60	1524	60.5	1537	68	1727	44.54	63.9	70.1	24945.8	11339	22451	10205



CLASS 300 – Trunnion Mounted Ball Valves

Size	Bore	End to End Dimensions						Body Dimensions			Flanged Weight		Butt Weld Weight	
in.	F (in.)	A-RF (in.)	A-RF (mm)	A-RTJ (in.)	A-RTJ (mm)	A-WE (in.)	A-WE (mm)	H1 (in.)	H2 (in.)	H3 (in.)	LB	KG	LB	KG
2 x 2	2	8.5	216	9.125	232	8.5	216	4.44	6.5	8.9	59.4	27	44	20
3 x 2	2	11.125	283	11.75	298	11.125	283	5.22	7.28	9.68	68.2	31	52.8	24
3 x 3	3	11.125	283	11.75	298	11.125	283	5.56	8.69	11.09	99	45	79.2	36
4 x 3	3	12	305	12.625	321	12	305	6.34	9.47	11.87	118.8	54	88	40
4 x 4	4	12	305	12.625	321	12	305	6.5	9.56	11.96	158.4	72	134.2	61
6 x 4	4	15.875	403	16.5	419	18	457	7.28	10.34	12.74	217.8	99	178.2	81
6 x 6	6	15.875	403	16.5	419	18	457	8.69	12.19	14.59	547.8	249	468.6	213
8 x 6	6	19.75	502	20.375	518	20.5	521	9.47	13.29	15.59	646.8	294	558.8	254
8 x 8	8	19.75	502	20.375	518	20.5	521	10.38	14.8	17.2	847	385	737	335
10 x 8	8	22.375	568	23	584	22	559	11.16	15.9	18.3	897.6	408	776.6	353
10 x 10	10	22.375	568	23	584	22	559	12.13	16.63	19.78	1245.2	566	1075.8	489
12 x 10	10	25.5	648	26.125	664	25	635	13.23	17.84	20.98	1645.6	748	1445.4	657
12 x 12	12	25.5	648	26.125	664	25	635	13.88	18.69	21.84	1894.2	861	1705	775
14 x 12	12	30	762	30.625	778	30	762	14.98	20	23.04	1995.4	907	1795.2	816
14 x 14	13.25	30	762	30.625	778	30	762	15.5	21	24.15	2593.8	1179	2294.6	1043
16 x 14	13.25	33	838	33.625	854	33	838	16.6	22.3	25.45	2893	1315	2644.4	1202
16 x 16	15.25	33	838	33.625	854	33	838	17.19	22.75	26.75	3440.8	1564	3093.2	1406
18 x 16	15.25	36	914	36.625	930	36	914	18.39	24.05	28.05	3940.2	1791	3542	1610
18 x 18	17.25	36	914	36.625	930	36	914	18.75	25.75	29.8	4987.4	2267	4490.2	2041
20 x 18	17.25	39	991	39.75	1010	39	991	20.05	27.05	31.1	5288.8	2404	4789.4	2177
20 x 20	19.25	39	991	39.75	1010	39	991	20.5	27.05	32.5	5486.8	2494	4987.4	2267
24 x 20	19.25	45	1143	45.875	1165	45	1143	21.9	28.8	33.9	5915.8	2698	5337.2	2426
24 x 24	23.25	45	1143	45.875	1165	45	1143	24.38	32.8	36.67	9229	4195	8430.4	3832
26 x 26	25	49	1245	50	1270	49	1245	34.83	50	55.91	11675.4	5307	10476.4	4762
28 x 28	27	53	1346	54	1372	53	1346	36.4	52.45	58.36	13970	6350	12573	5715
30 x 30	29	55	1397	56	1422	55	1397	38.77	55.75	61.95	16964.2	7711	15265.8	6939
36 x 36	34.5	68	1727	69.125	1756	68	1727	44.54	63.9	70.1	25944.6	11793	23350.8	10614



CLASS 600 – Trunnion Mounted Ball Valves

Size	Bore	End to End Dimensions						Body Dimensions			Flanged Weight		Butt Weld Weight	
in.	F (in.)	A-RF (in.)	A-RF (mm)	A-RTJ (in.)	A-RTJ (mm)	A-WE (in.)	A-WE (mm)	H1 (in.)	H2 (in.)	H3 (in.)	LB	KG	LB	KG
2 x 2	2	11.5	292	11.625	295	11.5	292	4.44	6.5	8.9	68.2	31	52.8	24
3 x 2	2	14	356	14.125	359	14	356	5.22	7.28	9.68	79.2	36	63.8	29
3 x 3	3	14	356	14.125	359	14	356	5.56	8.69	11.09	118.8	54	94.6	43
4 x 3	3	17	432	17.125	435	17	432	6.34	9.47	11.87	138.6	63	114.4	52
4 x 4	4	17	432	17.125	435	17	432	6.5	9.56	11.96	217.8	99	178.2	81
6 x 4	4	22	559	22.125	562	22	559	7.28	10.34	12.74	299.2	136	248.6	113
6 x 6	6	22	559	22.125	562	22	559	8.69	12.19	14.59	598.4	272	497.2	226
8 x 6	6	26	660	26.125	664	26	660	9.47	13.29	15.59	697.4	317	578.6	263
8 x 8	8	26	660	26.125	664	26	660	10.38	14.8	17.2	1196.8	544	976.8	444
10 x 8	8	31	787	31.125	791	31	787	11.16	15.9	18.3	1346.4	612	1075.8	489
10 x 10	10	31	787	31.125	791	31	787	12.13	16.63	19.78	1696.2	771	1375	625
12 x 10	10	33	838	33.125	841	33	838	13.23	17.84	20.98	1894.2	861	1535.6	698
12 x 12	12	33	838	33.125	841	33	838	13.88	18.69	21.84	2193.4	997	1775.4	807
14 x 12	12	35	889	35.125	892	35	889	14.98	20	23.04	2593.8	1179	2145	975
14 x 14	13.25	35	889	35.125	892	35	889	15.5	21	24.15	2943.6	1338	2393.6	1088
16 x 14	13.25	39	991	39.125	994	39	991	16.6	22.3	25.45	3291.2	1496	2743.4	1247
16 x 16	15.25	39	991	39.125	994	39	991	17.19	22.75	26.75	4538.6	2063	3740	1700
18 x 16	15.25	43	1092	43.125	1095	43	1092	18.39	24.05	28.05	5088.6	2313	4180	1900
18 x 18	17.25	43	1092	43.125	1095	43	1092	18.75	25.75	29.8	5876.2	2671	4809.2	2186
20 x 18	17.25	47	1194	47.25	1200	47	1194	20.05	27.05	31.1	6536.2	2971	5337.2	2426
20 x 20	19.25	47	1194	47.25	1200	47	1194	20.5	27.05	32.5	6635.2	3016	5438.4	2472
24 x 20	19.25	55	1397	55.325	1405	55	1397	21.9	28.8	33.9	7383.2	3356	6036.8	2744
24 x 24	23.25	55	1397	55.325	1405	55	1397	24.38	32.38	36.67	11523.6	5238	10227.8	4649
26 x 26	25	57	1448	57.5	1461	57	1448	31.74	40.74	45.64	13670.8	6214	11475.2	5216
28 x 28	27	61	1549	61.5	1562	61	1549	38.85	44.76	50.67	22451	10205	20207	9185
30 x 30	29	65	1651	65.5	1664	65	1651	42	48.2	54.4	23949.2	10886	21553.4	9797
36 x 36	34.5	82	2083	82.625	2099	82	2083	47.34	53.54	59.74	37620	17100	33827	15376

CLASS 900 – Trunnion Mounted Ball Valves

Size	Bore	End to End Dimensions						Body Dimensions			Flanged Weight		Butt Weld Weight	
		in.	F (in.)	A-RF (in.)	A-RF (mm)	A-RTJ (in.)	A-RTJ (mm)	A-WE (in.)	A-WE (mm)	H1 (in.)	H2 (in.)	H3 (in.)	LB	KG
2 x 2	2	14.5	368	14.625	371	14.5	368	4.44	7.28	10.9	118.8	54	94.6	43
3 x 2	2	15	381	15.125	384	15	381	5.22	8.06	11.64	138.6	63	107.8	49
3 x 3	3	15	381	15.125	384	15	381	5.56	9.47	13.05	178.2	81	143	65
4 x 3	3	18	457	18.125	460	18	457	6.34	10.25	13.84	217.8	99	173.8	79
4 x 4	4	187	4750	18.125	460	187	4750	6.5	10.34	13.92	319	145	224.4	102
6 x 4	4	24	610	24.125	613	24	610	7.28	11.12	14.7	437.8	199	347.6	158
6 x 6	6	24	610	24.125	613	24	610	8.69	12.97	16.55	697.4	317	558.8	254
8 x 6	6	29	737	29.125	740	29	737	9.47	14.07	17.65	897.6	408	717.2	326
8 x 8	8	29	737	29.125	740	29	737	10.38	15.58	19.1	1546.6	703	1236	562
10 x 8	8	33	838	33.125	841	33	838	11.16	16.68	20.26	1595	725	1276	580
10 x 10	10	33	838	33.125	841	33	838	12.13	17.41	21.74	1846	839	1476	671
12 x 10	10	38	965	38.125	968	38	965	13.23	18.62	22.94	2295	1043	1846	839
12 x 12	12	38	965	38.125	968	38	965	13.88	19.47	23.8	2593	1315	2343	1065
14 x 12	12	40.5	1029	40.875	1038	40.5	1029	14.98	20.77	25	3392	1542	2743	1247
14 x 14	12.75	40.5	1029	40.875	1038	40.5	1029	15.5	21.78	26.11	3841	1746	3093	1406
16 x 14	12.75	44.5	1130	44.875	1140	44.5	1130	16.6	23.1	27.41	3991	1814	3192	1451
16 x 16	14.75	44.5	1130	44.875	1140	44.5	1130	17.19	23.53	28.71	4739	2154	3791	1723
18 x 16	14.75	48	1219	48.5	1232	48	1219	18.39	24.83	30.01	5438	2472	4239	1927
18 x 18	16.75	48	1219	48.5	1232	48	1219	18.75	26.53	31.75	7031	3197	5636	2562
20 x 18	16.75	52	1321	52.5	1334	52	1321	20.05	27.83	33.05	8532	3878	6835	3107
20 x 20	18.625	52	1321	52.5	1334	52	1321	20.5	28.3	34.46	10027.6	4558	8032	3651
24 x 20	18.625	61	1549	61.75	1568	61	1549	21.9	29.58	35.86	11436	5198	9130	4150
24 x 24	22.5	61	1549	61.75	1568	61	1549	24.38	33.2	38.63	13372	6078	10727	4876

CLASS 1500 – Trunnion Mounted Ball Valves

Size	Bore	End to End Dimensions						Body Dimensions			Flanged Weight		Butt Weld Weight	
		in.	F (in.)	A-RF (in.)	A-RF (mm)	A-RTJ (in.)	A-RTJ (mm)	A-WE (in.)	A-WE (mm)	H1 (in.)	H2 (in.)	H3 (in.)	LB	KG
2 x 2	2	14.5	368	14.625	371	14.5	368	6.5	4.44	8.9	119	54	95	43
3 x 2	2	18.5	470	18.625	473	18.5	470	7.28	5.22	9.68	170	77	155	71
3 x 3	3	18.5	470	18.625	473	18.5	470	8.69	5.56	11.09	240	109	185	84
4 x 3	3	21.5	546	21.625	549	21.5	546	9.47	6.34	11.87	320	145	265	120
4 x 4	4	21.5	546	21.625	549	21.5	546	9.56	6.5	11.96	420	191	280	127
6 x 4	4	27.75	705	28	711	27.75	705	10.34	7.28	12.74	650	295	540	245
6 x 6	6	27.75	705	28	711	27.75	705	12.19	8.69	14.59	1190	541	900	409
8 x 6	6	32.75	832	33.125	841	32.75	832	13.29	9.47	15.59	1450	659	980	445
8 x 8	8	32.75	832	33.125	841	32.75	832	14.8	10.38	17.2	1936	880	1355	616
10 x 8	8	39	991	39.375	1000	39	991	15.9	11.16	18.3	2380	1082	1666	757
10 x 10	10	39	991	39.375	1000	39	991	16.63	12.13	19.78	3420	1555	2394	1088
12 x 10	10	44.5	1130	45.125	1146	44.5	1130	17.84	13.23	20.98	4070	1850	2849	1295
12 x 12	12	44.5	1130	45.125	1146	44.5	1130	18.69	13.88	21.84	5120	2327	3500	682
14 x 12	12	49.5	1257	50.25	1276	49.5	1257	20	14.98	23.04	5741	2606	4020	1827
14 x 14	13.25	49.5	1257	50.25	1276	49.5	1257	21	15.5	24.15	6259	2845	4310	1959
16 x 14	13.25	54.5	1384	55.375	1407	54.5	1384	22.3	16.6	25.45	6678	3035	5640	2564
16 x 16	15.25	54.5	1384	55.375	1407	54.5	1384	22.75	17.19	26.75	9210	4186	7668	3485
18 x 16	15.25	57	1448	57.5	1461	57	1448	24.05	18.39	28.05	12180	5536	9740	4427
18 x 18	17.25	57	1448	57.5	1461	57	1448	25.75	18.75	29.8	14260	6482	11420	5191
20 x 18	17.25	61	1549	61.5	1562	61	1549	27.05	20.05	31.1	17360	7891	14800	6727
20 x 20	19.25	61	1549	61.5	1562	61	1549	27.05	20.5	32.5	20550	9341	17467	7940
24 x 20	19.25	65	1651	65.5	1664	65	1651	28.8	21.9	33.9	23820	10830	19120	8690
24 x 24	23.25	65	1651	65.5	1664	65	1651	32.38	24.38	36.67	27590	12540	23450	10660

CLASS 2500 – Trunnion Mounted Ball Valves

Size	Bore	End to End Dimensions						Body Dimensions			Flanged Weight		Butt Weld Weight	
		in.	F (in.)	A-RF (in.)	A-RF (mm)	A-RTJ (in.)	A-RTJ (mm)	A-WE (in.)	A-WE (mm)	H1 (in.)	H2 (in.)	H3 (in.)	LB	KG
2 x 2	2	19.75	502	17.875	454.03	17.75	450.85	7.28	4.44	10.9	225	115	216	99
3 x 2	2	22.75	578	23	584.20	22.75	577.85	8.06	5.22	11.64	305	140	260	120
3 x 3	3	22.75	578	23	584.20	22.75	577.85	9.47	5.56	13.05	440	200	374	170
4 x 3	3	26.5	673	26.875	682.63	26.5	673.1	10.25	6.34	13.84	620	280	527	240
4 x 4	4	26.5	673	26.875	682.63	26.5	673.1	10.34	6.5	13.92	825	370	701	314
6 x 4	4	36	914	36.5	927.10	36	914.4	11.12	7.28	14.7	1270	580	1080	490
6 x 6	6	36	914	36.5	927.10	36	914.4	12.97	8.69	16.55	1790	800	1521	680
8 x 6	6	40.25	1022	40.875	1038.23	40.25	1022.35	14.07	9.47	17.65	2630	1195	2235	995
8 x 8	8	40.25	1022	40.875	1038.23	40.25	1022.35	15.58	10.38	19.1	3500	1600	2975	1360
10 x 8	8	50	1270	50.875	1292.23	50	1270	16.68	11.16	20.26	4750	2160	4030	1830
10 x 10	10	50	1270	50.875	1292.23	50	1270	17.41	12.13	21.74	5400	2500	4590	2940
12 x 10	10	56	1422	56.875	1444.63	56	1422.4	18.62	13.23	22.94	6620	3010	5620	2550
12 x 12	12	56	1422	56.875	1444.63	56	1422.4	19.47	13.88	23.8	8300	4000	7055	3400
14 x 12	12	57	1448	57.875	1470.03	57	1447.8	20.77	14.98	25	9880	4990	7900	3590
14 x 14	12.75	57	1448	57.875	1470.03	57	1447.8	21.78	15.5	26.11	12250	3560	10020	4550
16 x 14	12.75	58	1473	58.875	1495.43	58	1473.2	23.1	16.6	27.41	14320	6510	11450	3200
16 x 16	14.75	58	1473	58.875	1495.43	58	1473.2	23.53	17.19	28.71	16890	7670	13510	6140
18 x 16	14.75	59	1499	59.875	1520.83	59	1498.6	24.83	18.39	30.01	19110	8690	15280	6945
18 x 18	16.75	59	1499	59.875	1520.83	59	1498.6	26.53	18.75	31.75	21150	9610	16920	7690
20 x 18	16.75	60	1524	60.875	1546.23	60	1524	27.83	20.05	33.05	22950	10430	18360	8345
20 x 20	18.625	60	1524	60.875	1546.23	60	1524	28.3	20.5	34.46	24630	11195	19690	8950
24 x 20	18.625	61	1549	61.75	1568.45	61	1549.4	29.58	21.9	35.86	27350	12431	21880	9945
24 x 24	22.5	61	1549	61.75	1568.45	61	1549.4	33.2	24.38	38.63	29140	13245	23310	10600

BALL VALVE FLOW COEFFICIENCY

Size	Class					
	150	300	600	900	1500	2500
2 x 2	500	500	350	320	320	295
3 x 2	220	220	190	185	180	295
3 x 3	1390	1390	1000	910	820	735
4 x 3	630	630	560	505	500	735
4 x 4	2550	2550	1850	1760	1610	1450
6 x 4	925	925	800	730	730	1450
6 x 6	5249	5249	4400	4300	4080	2530
8 x 6	2500	2500	2150	2010	2005	2530
8 x 8	10750	10750	8450	8400	7980	5400
10 x 8	500	5000	4500	4160	4150	5400
10 x 10	17775	17775	14250	14160	13020	8430
12 x 10	8400	8400	8000	7300	7280	8430
12 x 12	26750	26750	22790	21230	16910	12345
14 x 12	14080	14080	13990	13920	13810	12345
14 x 14	32600	326000	28600	26600	24080	-
16 x 14	14780	14780	14720	14690	-	-
16 x 16	44700	44700	39250	36600	33110	-
18 x 16	20840	20840	20750	20700	-	-
18 x 18	58500	58500	52000	50540	50360	-
20 x 18	28100	28100	27850	27840	-	-
20 x 20	76000	76000	70500	69700	64750	-
24 x 20	29000	29000	28750	26950	-	-
24 x 24	113500	113500	99000	86750	77460	-

Face to face dimensions to ANSI B16.10.

The Flow Coefficient (Cv) of a valve is the rate of gallons per minute of water at 60°F through a fully opened valve at a pressure drop of 1 PSI across the valve.

Dimensions and values should only be used as a guide.

Please contact us if you require a specific drawing or confirmation of dimensions and values.